

INSTL HOUSING

GREEN

RESIDENTIAL

GREEN

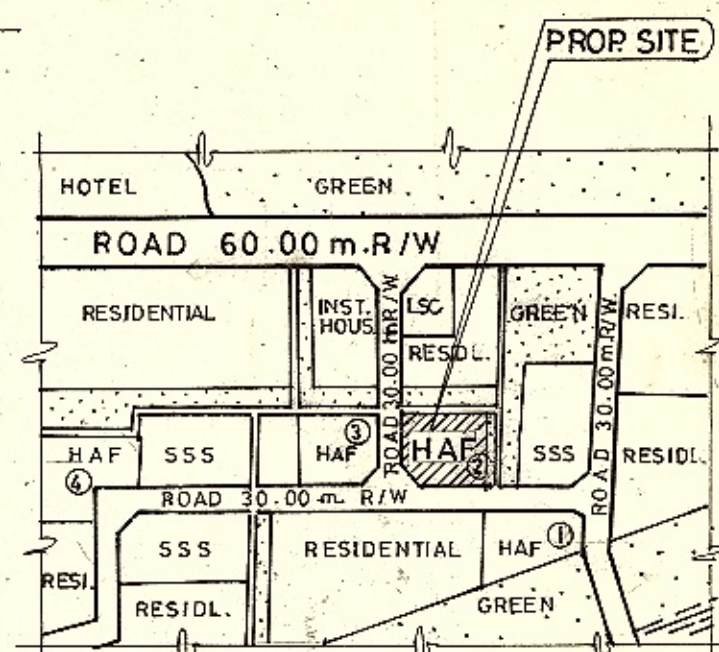

KEY PLAN

# द्वारका उपशहर परियोजना

## AREA STATEMENT

TOTAL AREA OF THE PLOT...12445.82 Sq.m.

Sr.No.	FACILITY	AREA IN Sq.m.	MAX.Gr. COVERAGE	FAR	MAX.Ht.
1.	CONVENIENT SHOPPING CENTRE including M.B.&V.B.	1459.05	AS/M.P.D. 2001		
2.	PRIMARY SCHOOL	4000.36			
3.	NURSERY SCHOOL.1	799.94			
4.	NURSERY SCHOOL.2	799.94			
5.	RELEGIOS BUILDING.1	400.09			
6.	RELEGIOS BUILDING.2	400.09			
7.	COMMUNITY HALL	2001.59			
8.	COMMUNITY ROOM	660.20			
9.	TAXI STAND	550.29			
10.	CIRCULATION	1232.52			
11.	E.S.S.	141.75			

### NOTES...

- DO NOT SCALE THE DRAWING, FOLLOW ONLY THE WRITTEN DIMENSION.
- ALL DIMENSIONS ARE IN METRE
- CHECK ALL THE DIMENSIONS AT SITE BEFORE EXECUTION

APPROVED VIDE COMMISSIONER (PLANNING) ORDER DT. 22.4.98.  
VIDE FILE NO. F-8(10)94-DWK/HAF-B/PART-II AT PAGE 6/N.

- THE PLAN IS SUBJECT TO MODIFICATIONS WITHIN THE FRAMEWORK OF MASTER PLAN/ZONAL PLAN.
- IT IS FOR PLANNING PURPOSE & IS NOT FIT TO BE PRODUCED IN THE COURT OF LAW FOR PROPERTY DISPUTES.
- ALL THE DIMENSIONS & AREA GIVEN IN THE PLAN ARE CONFIRMATION OF OWNERSHIP/ALLOTMENT STATUS & DEMARCATIONS/FEASIBILITY REPORT FROM THE DDA LANDS & ENGINEERING WING RESPECTIVELY.

H.A.E.3

ROAD 30.00 m. R/W

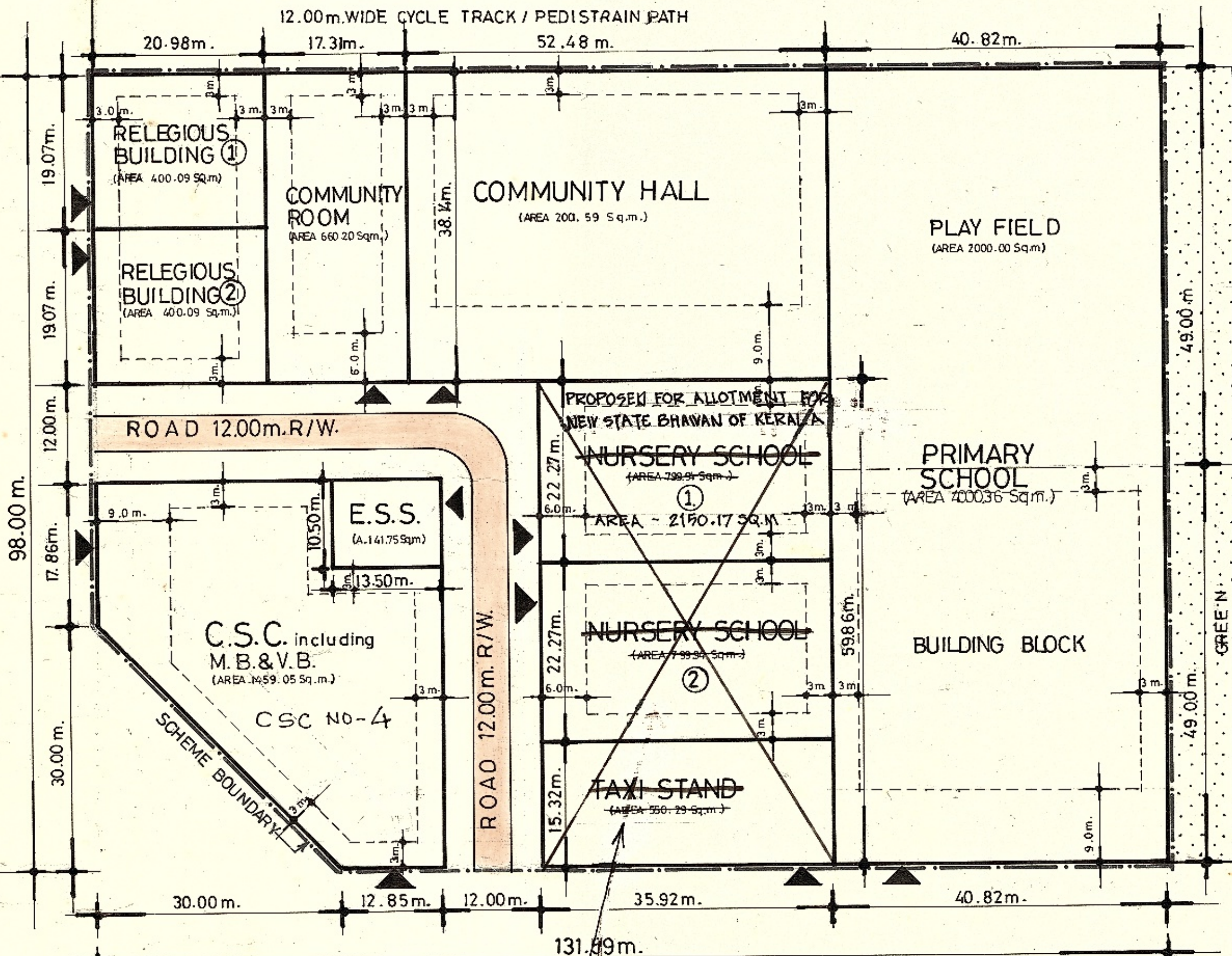

ROAD 30.00 m. R/W

APPROVED BY 900TH SCREENING COMMITTEE MEETING HELD ON DT. 8.08.11  
VIDE ITEM NO. 60/2011 TO MERGE N.S. SITE-1 AND N.S. SITE-2, ALONG WITH  
THE TAXI STAND SITE INTO ONE SINGLE PARCEL OF LAND WHICH MAY BE CONSI-  
DERED FOR ALLOTMENT FOR THE NEW STATE BHAVAN OF KERALA.

RESIDENTIAL

H.A.F.1

## HOUSING AREA FACILITY H.A.F. 2 SECTOR-19 PH.II

# DWARAKA SUB-CITY (PAIPANKALA)

### LAYOUT PLAN

0 5 10 15 20 25 30 35			DRG.NO. DWK/SEC19/HAF/97/37
1:500			SCALE
AUG. 97			DATE
(S.P.VERMA) PLG. D/MAN.	(S.P.KAUR) PLG. ASSTT.	(M.L.CHABRA) ASSTT. DIR.	
(A.K.MANRA) DY.DIR.	(A.K.GUPTA) DIRE CTOR	(N.K.AGGARWAL) O'S D (PLG.)	(VIJAY RISHBUD) COMMISSIONER (PLG.)
दिल्ली	विकास	प्राधिकरण	